

**DO NOT SCALE**

**LEGEND**

- PROPOSED DCO ORDER LIMITS
- GAS PIPELINE ALIGNMENT

**POWER STATION SITE**

ITEM	DESCRIPTION
1	GAS TURBINE BUILDING
2	BYPASS STACK
3	HRSG BUILDING AND MAIN STACK
4	TRANSFORMER AREA
5	POWER CONTROL CENTRES
6	FEEDWATER PUMPHOUSE
7	FUEL GAS STATION MAIN
8	MAIN PIPE RACK
9	GAS RECEIVING FACILITY
10	GAS COMPRESSOR BUILDING
11	GAS INSULATED SWITCH GEAR
12	REINSTATED SLUDGE LAGOONS
13	BATTERY ENERGY STORAGE FACILITY
14	TURBINE OUTAGE STORE (TOS) BUILDING
15	CONNECTION POINT TO 400KV SUBSTATION FOR NEW UNITS
16	FLOOD MITIGATION CHANNEL

**GAS ABOVE GROUND INSTALLATION (AGI)**

ITEM	DESCRIPTION
17	AGI (MINIMUM OFFTAKE CONNECTION) (NATIONAL GRID)
18	AGI (DRAX FACILITY)

**TRAFFIC MANAGEMENT**

ITEM	DESCRIPTION
19	TEMPORARY PASSING PLACE FOR GAS AGI CONSTRUCTION TRAFFIC

**CONTRACTOR'S VILLAGE**

ITEM	DESCRIPTION
A	CAR PARKING
B	STORES AND WORKSHOP
C	CONTRACTOR'S MODULAR BUILDINGS
D	CONTRACTOR'S WELFARE OFFICES
E	ACCESS ROAD
F	COOLING WATER SPRAY SCREEN

Infrastructure Planning (Applications: Prescribed Forms and Procedure) Regulations 2009 - Regulation 5(2) (e)

REV	DATE	BY	DESCRIPTION	CHK	APP
01	27/04/2018	SPS	Final Issue		

**SUBMISSION FOR REFERENCE**

Westbrook Mills, Borough Road, Godalming, GU7 2AZ, UK  
T: +44 (0) 1483 520 400 F: +44 (0) 1483 520 989  
wsp.com

**PROJECT:**  
The Drax Power (Generating Stations) Order

**TITLE:**  
Application Document Reference 2.5B  
Single Unit Option  
Indicative Plant Layout  
Key Plan - Sheet 1 of 9

SCALE	DRAWN	CHECKED	DATE
1:5000	R.MAKIN	B.SIBTHORP	27/04/2018

PROJECT NO.	DATE	REV.
70037047	27/04/2018	01

70037047-2.5B-IPL - SHEET 1

© WSP UK Ltd

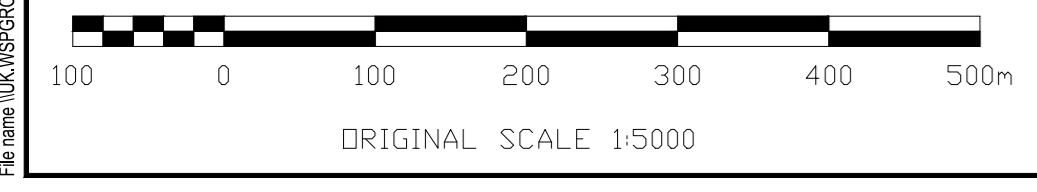

W:\Projects\2018\70037047\2.5B-IPL\2.5B-IPL-Key Plan - Sheet 1 of 9.dwg  
 27/04/2018 14:03:56  
 R:\Users\RM\OneDrive\Documents\2018\70037047\2.5B-IPL\2.5B-IPL-Key Plan - Sheet 1 of 9.dwg  
 27/04/2018 14:03:56

DO NOT SCALE

LEGEND  
— PROPOSED DCO ORDER LIMITS

POWER STATION SITE

ITEM	DESCRIPTION
1	GAS TURBINE BUILDING
2	BYPASS STACK
3	HRSG BUILDING AND MAIN STACK
4	TRANSFORMER AREA
5	POWER CONTROL CENTRES
6	FEEDWATER PUMPHOUSE
7	FUEL GAS STATION MAIN
8	MAIN PIPE RACK
9	GAS RECEIVING FACILITY
10	GAS COMPRESSOR BUILDING
11	GAS INSULATED SWITCH GEAR
12	REINSTATED SLUDGE LAGOONS
13	BATTERY ENERGY STORAGE FACILITY
14	TURBINE OUTAGE STORE (TOS) BUILDING
15	CONNECTION POINT TO 400KV SUBSTATION FOR NEW UNITS
16	FLOOD MITIGATION CHANNEL



Infrastructure Planning (Applications: Prescribed Forms and Procedure) Regulations 2009 - Regulation 5(2) (e)

REV	DATE	BY	DESCRIPTION	CHK	APP
01	27/04/2018	SPS	Final Issue	RM	BS

ISSUING STATUS: SUBMISSION FOR REFERENCE



Westbrook Mills, Borough Road, Godalming, GU7 2AZ, UK  
T: +44 (0) 1483 528 400, F: +44 (0) 1483 528 889  
wsp.com



The Drax Power (Generating Stations) Order

Application Document Reference 2.5B  
Single Unit Option  
Indicative Plant Layout  
- North of Site - Sheet 2 of 9

SCALE	DRAWN	CHECKED	APPROVED
1:750	B.SIBTHORP	R.MAKIN	B.SIBTHORP

PROJECT NO.	ISSUED	DATE
70037047	B.SIBTHORP	27/04/2018

PROJECT	REV
70037047-2.5B-IPL - SHEET 2	01

© WSP UK Ltd

DO NOT SCALE

- LEGEND
- PROPOSED DCO ORDER LIMITS
  - GAS PIPELINE ALIGNMENT

POWER STATION SITE

ITEM	DESCRIPTION
1	GAS TURBINE BUILDING
2	BYPASS STACK
3	HRSG BUILDING AND MAIN STACK
4	TRANSFORMER AREA
5	POWER CONTROL CENTRES
6	FEEDWATER PUMPHOUSE
7	FUEL GAS STATION MAIN
8	MAIN PIPE RACK
9	GAS RECEIVING FACILITY
10	GAS COMPRESSOR BUILDING
11	GAS INSULATED SWITCH GEAR
12	REINSTATED SLUDGE LAGOONS
13	BATTERY ENERGY STORAGE FACILITY
14	TURBINE OUTAGE STORE (TOS) BUILDING
15	CONNECTION POINT TO 400KV SUBSTATION FOR NEW UNITS
16	FLOOD MITIGATION CHANNEL

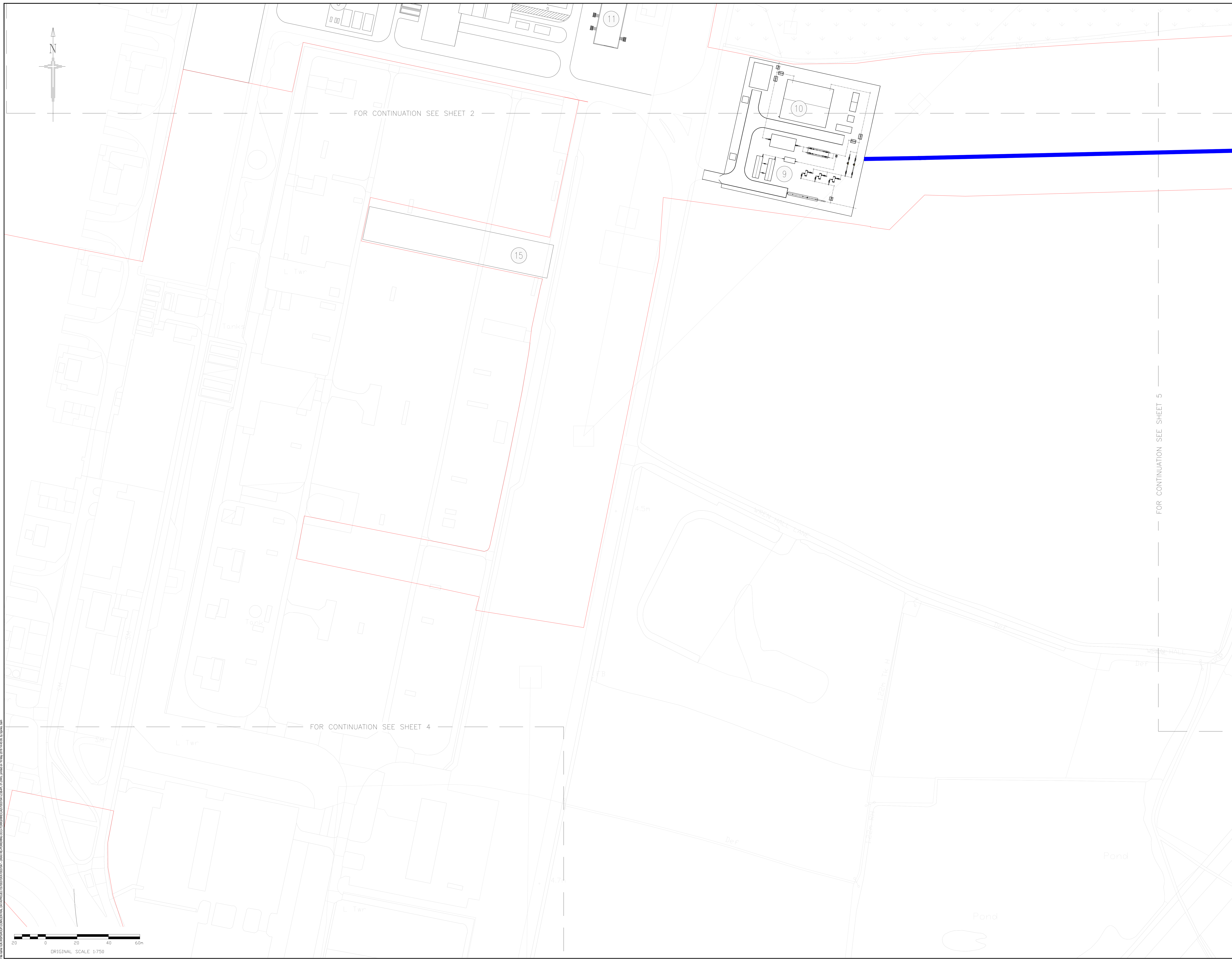

FOR CONTINUATION SEE SHEET 2

FOR CONTINUATION SEE SHEET 4

FOR CONTINUATION SEE SHEET 5

Infrastructure Planning (Applications: Prescribed Forms and Procedure) Regulations 2009 - Regulation 5(2) (e)

REV	DATE	BY	DESCRIPTION	CHK	APP
01	27/04/2018	SPS	Final Issue	RM	BS

STATUS: SUBMISSION FOR REFERENCE



Westbrook Mills, Borough Road, Godalming, GU7 2AZ, UK  
T: +44 (0) 1483 528 400, F: +44 (0) 1483 528 889  
wsp.com



CLIENT: The Drax Power (Generating Stations) Order

PROJECT: Application Document Reference 2.5B  
Single Unit Option  
Indicative Plant Layout  
- Centre of Site - Sheet 3 of 9

SCALE	DRAWN	CHECKED	APPROVED
1:750	R.M.MUN	B.SIBTHORP	B.SIBTHORP

PROJECT NO.	ISSUED FOR	DATE
70037047	B.SIBTHORP S.SPINS	27/04/2018

70037047-2.5B-IPL - SHEET 3	01
-----------------------------	----

© WSP UK Ltd

Reference to WSP's Confidential Data and/or Information is hereby made. It is the property of WSP and is not to be disclosed to any third party without the prior written consent of WSP.

20 0 20 40 60m  
ORIGINAL SCALE 1:750

DO NOT SCALE

LEGEND  
— PROPOSED DCO ORDER LIMITS

CONTRACTOR'S VILLAGE

ITEM	DESCRIPTION
A	CAR PARKING
B	STORES AND WORKSHOP
C	CONTRACTOR'S MODULAR BUILDINGS
D	CONTRACTOR'S WELFARE OFFICES
E	ACCESS ROAD
F	COOLING WATER SPRAY SCREEN

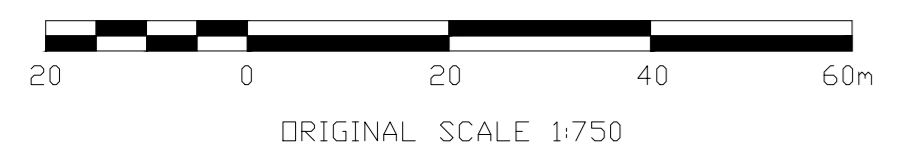
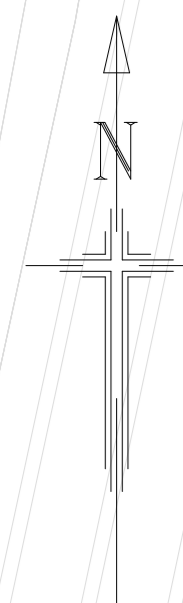

Infrastructure Planning (Applications: Prescribed Buildings and Procedure) Regulations 2009 - Regulation 5(2) (e)

REV	DATE	BY	DESCRIPTION	CHK	APP
01	27/04/2018	SPS	Final Issue	RM	BS

CONTRACT STATUS: SUBMISSION FOR REFERENCE

Westbrook Mills, Borough Road, Colindale, GUY 2AZ, UK  
T: +44 (0) 1463 520 400, F: +44 (0) 1463 520 889  
wsp.com

PROJECT: The Drax Power (Generating Stations) Order

TITLE: Application Document Reference 2.5B  
Single Unit Option  
Indicative Plant Layout  
- South of Site - Sheet 4 of 9

SCALE: 1:750	CHECKED: R.M.MUN	APPROVED: B.SIBTHORP
PROJECT NO: 70037047	DESIGNED: B.SIBTHORP	DATE: 27/04/2018

70037047-2.5B-IPL - SHEET 4 01

© WSP UK Ltd

DO NOT SCALE

LEGEND  
— PROPOSED DCO ORDER LIMITS  
— GAS PIPELINE ALIGNMENT

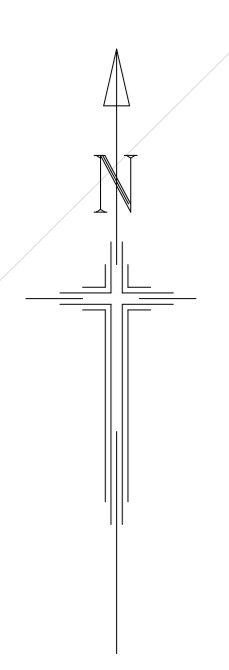

FOR CONTINUATION SEE SHEET 2

FOR CONTINUATION SEE SHEET 4

FOR CONTINUATION SEE SHEET 6

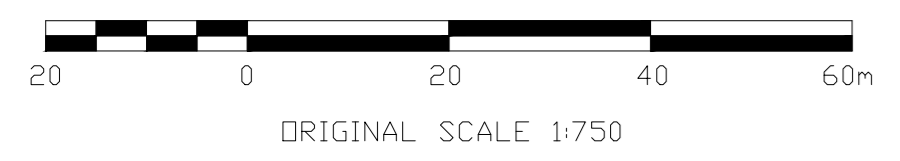
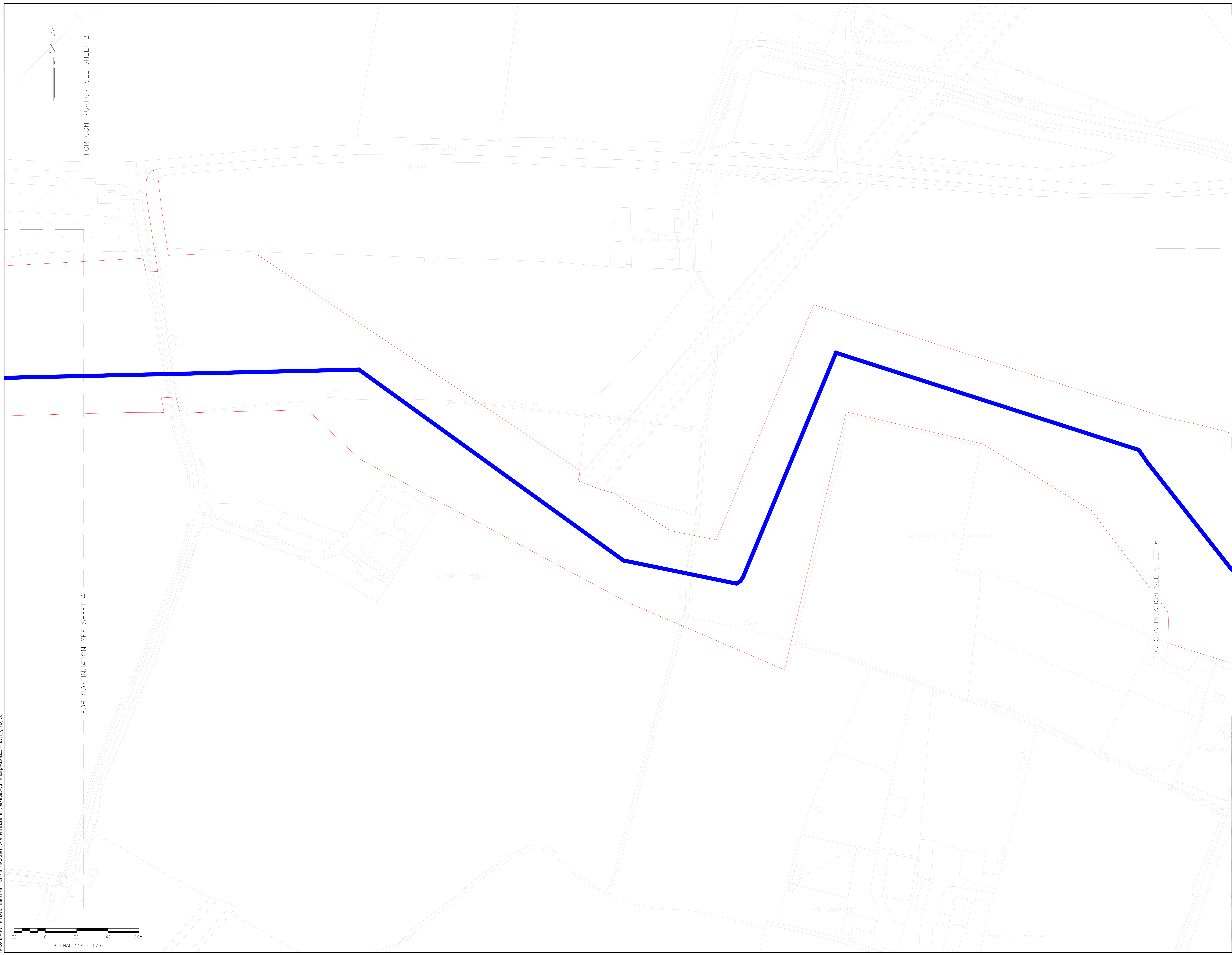

Infrastructure Planning (Applications: Prescribed Forms and Procedure) Regulations 2009 - Regulation 5(2) (e)

REV	DATE	BY	DESCRIPTION	CHK	APP
01	27/04/2018	SPS	Final Issue	RM	BS

CONTRACT STATUS: SUBMISSION FOR REFERENCE



Westbrook Mills, Borough Road, Godalming, GU7 2AZ, UK  
T: +44 (0) 1463 520 400 F: +44 (0) 1463 520 889  
wsp.com



CLIENT: The Drax Power (Generating Stations) Order

PROJECT: Application Document Reference 2.5B  
Single Unit Option  
Indicative Plant Layout  
- Gas Pipeline Route - Sheet 5 of 9

SCALE: 1:750	CHECKED: R.M.MUN	APPROVED: B.SIBTHORP
PROJECT NO: 70037047	DESIGNED: B.SIBTHORP	DATE: 27/04/2018
DRAWN BY: S.SPINKS	REV:	

70037047-2.5B-IPL - SHEET 5 01

© WSP UK Ltd

DO NOT SCALE

- LEGEND**
- PROPOSED DCO ORDER LIMITS
  - GAS PIPELINE ALIGNMENT

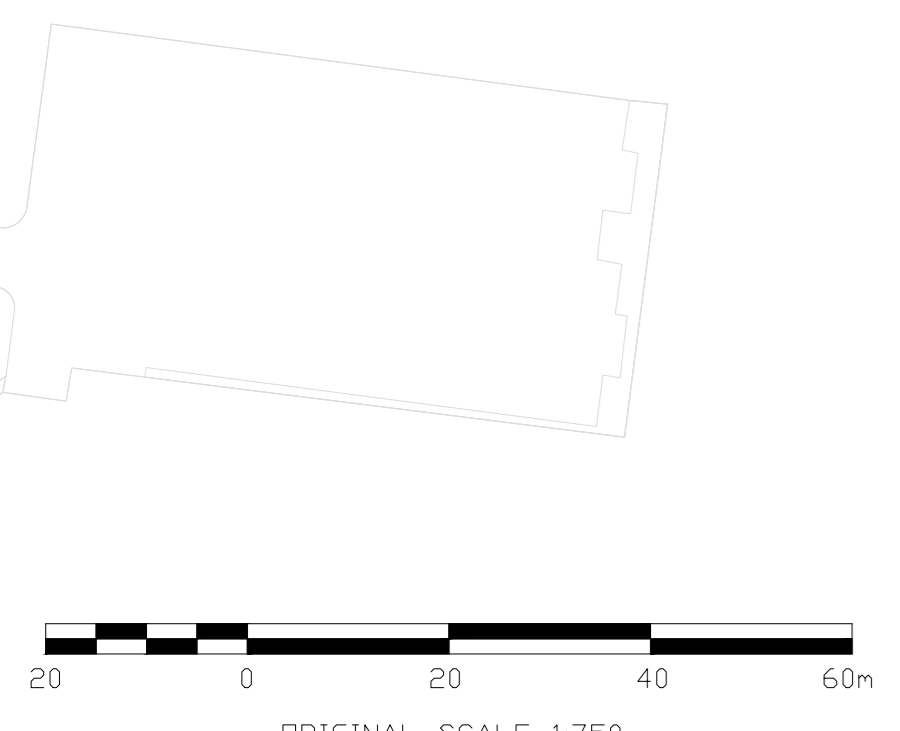
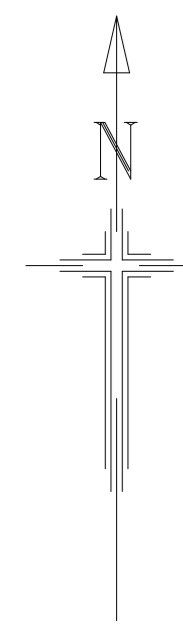

Infrastructure Planning (Applications: Prescribed Forms and Procedure) Regulations 2009 - Regulation 5(2) (e)

REV	DATE	BY	DESCRIPTION	CHK	APP
01	27/04/2018	SPS	Final Issue	RM	BS

**SUBMISSION FOR REFERENCE**

Westbrook Mills, Borough Road, Godalming, GU7 2AZ, UK  
T: +44 (0) 1463 520 400 F: +44 (0) 1463 520 889  
wsp.com

CLIENT:

PROJECT:  
The Drax Power (Generating Stations) Order

TITLE:  
Application Document Reference 2.5B  
Single Unit Option  
Indicative Plant Layout  
- Gas Pipeline Route - Sheet 6 of 9

SCALE 0/AS	1/750	CHECKED	R.M.MUN	APPROVED	B.SIBTHORP
PROJECT NO.	70037047	DESIGNED	B.SIBTHORP	DATE	27/04/2018
DRAWING NO.	70037047-2.5B-IPL - SHEET 6	REV.			01

© WSP UK Ltd

DO NOT SCALE

LEGEND  
— PROPOSED DCO ORDER LIMITS  
— GAS PIPELINE ALIGNMENT

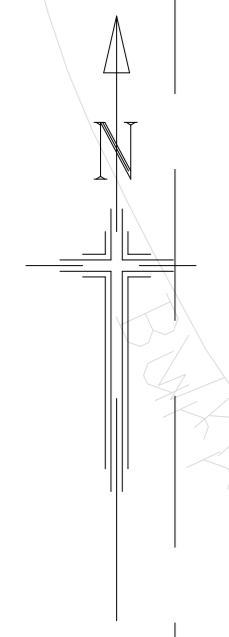
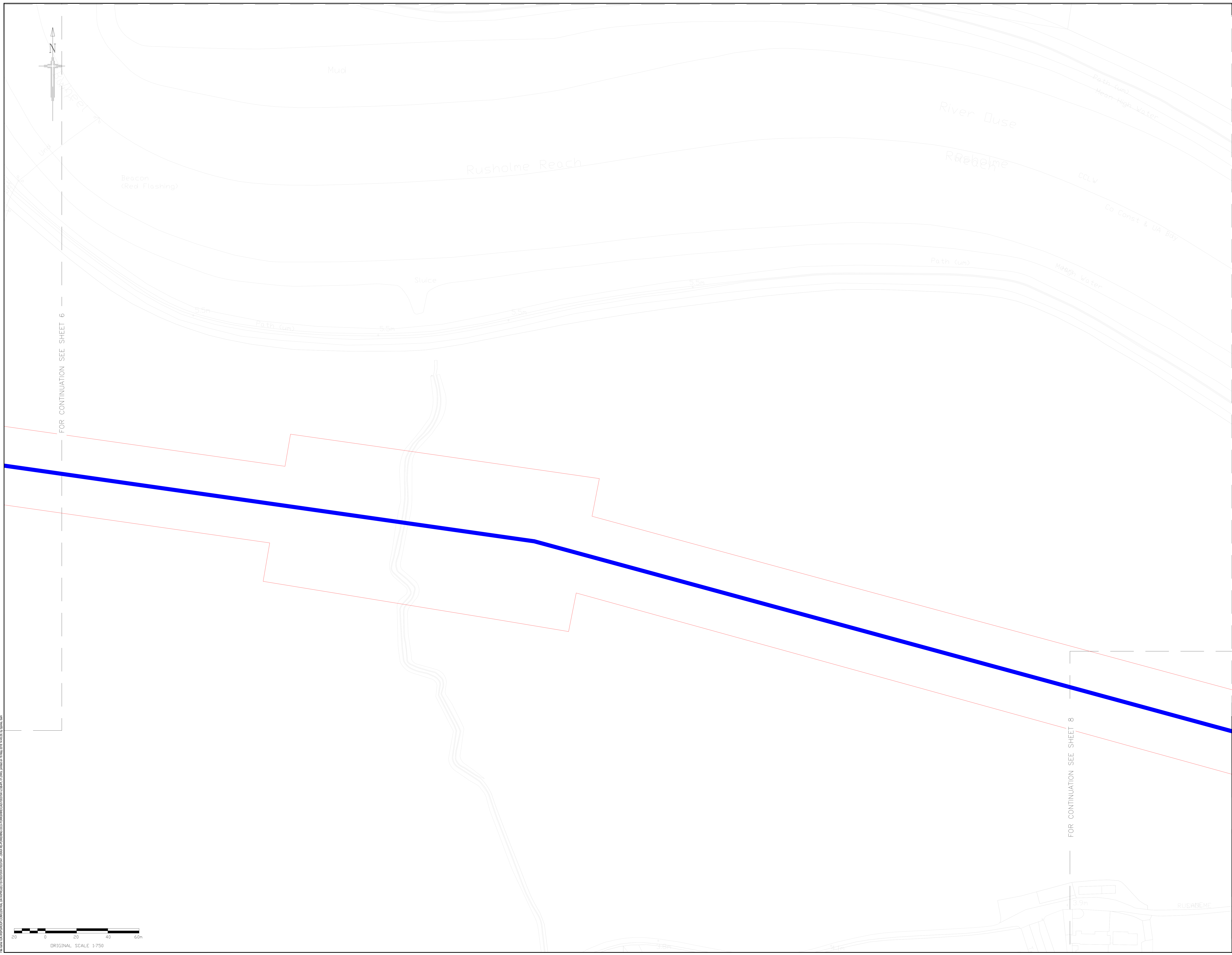

FOR CONTINUATION SEE SHEET 6

FOR CONTINUATION SEE SHEET 8

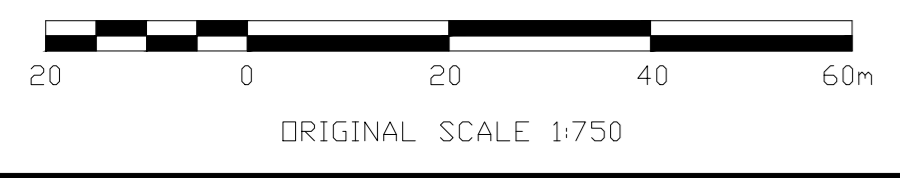

Infrastructure Planning (Applications: Prescribed Forms and Procedure) Regulations 2009 - Regulation 5(2) (e)

REV	DATE	BY	DESCRIPTION	CHK	APP
01	27/04/2018	SPS	Final Issue	RM	BS

DRAWING STATUS: SUBMISSION FOR REFERENCE



Westbrook Mills, Borough Road, Godalming, GU7 2AZ, UK  
T: +44 (0) 1483 520 400 F: +44 (0) 1483 520 889  
wsp.com



CLIENT:  
The Drax Power  
(Generating Stations) Order

PROJECT:  
Application Document Reference 2.5B  
Single Unit Option  
Indicative Plant Layout  
- Gas Pipeline Route - SHEET 7 of 9

SCALE: 1:750	CHECKED: R.M.MUN	APPROVED: B.SIBTHORP
PROJECT NO: 70037047	DESIGNED: B.SIBTHORP	DATE: 27/04/2018
DRAWN BY: S.SPINKS	REV:	

70037047-2.5B-IPL - SHEET 7 01

© WSP UK Ltd

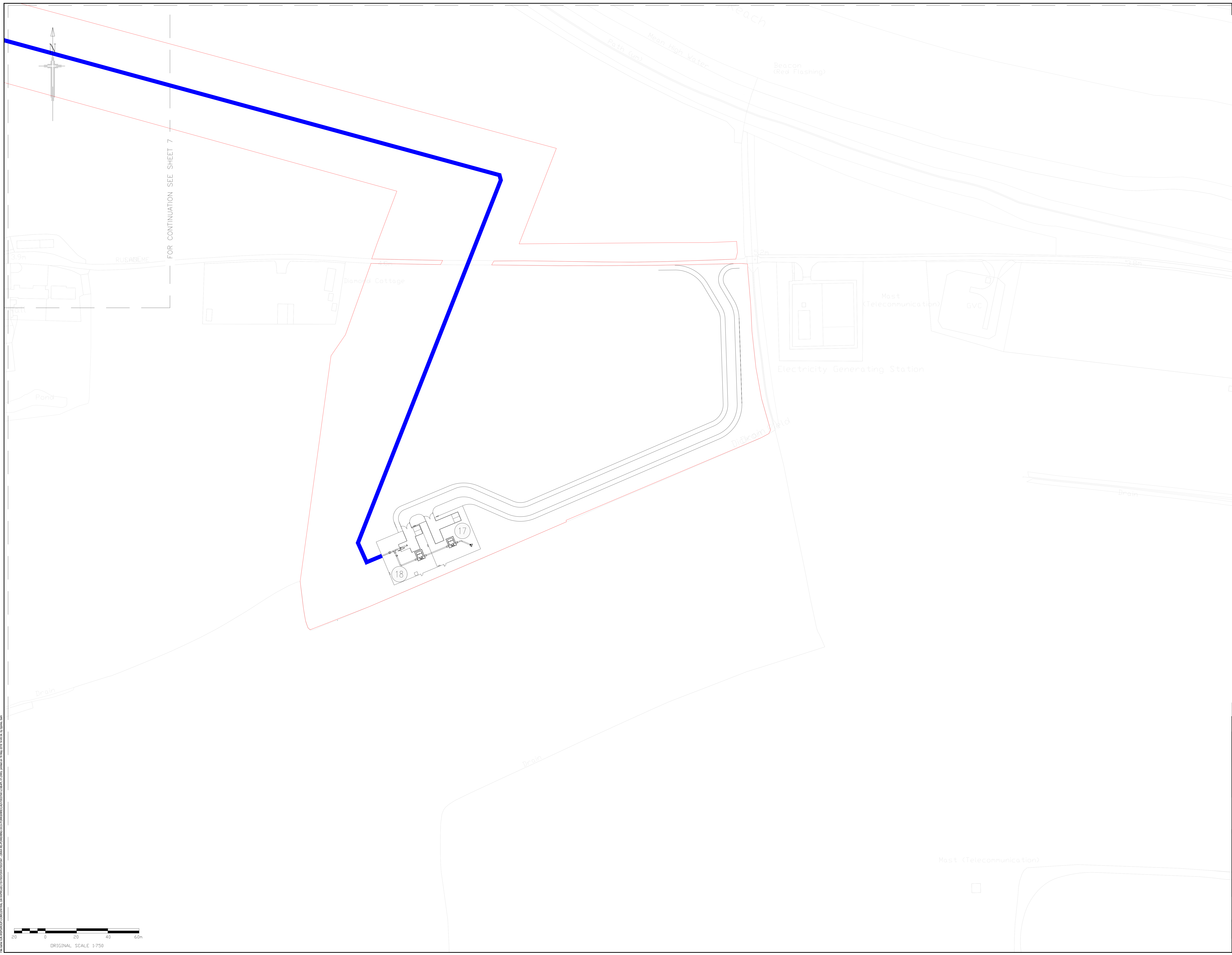

FOR CONTINUATION SEE SHEET 7

**DO NOT SCALE**

**LEGEND**  
 — PROPOSED DCO ORDER LIMITS  
 — GAS PIPELINE ALIGNMENT

**GAS ABOVE GROUND  
 INSTALLATION (AGI)**

ITEM	DESCRIPTION
17	AGI (MINIMUM OFFTAKE CONNECTION) (NATIONAL GRID)
18	AGI (DRAX FACILITY)

3.9m

RUSHMORE

Diamond Cottage

Beacon (Red Flashing)

Most (Telecommunication)

GVD

Electricity Generating Station

Pond

Drain

Drain

Drain

Most (Telecommunication)

0 20 40 60m  
 ORIGINAL SCALE 1:750

Infrastructure Planning (Applications: Prescribed Forms and Procedure) Regulations 2009 - Regulation 5(2) (e)

REV	DATE	BY	DESCRIPTION	CHK	APP
01	27/04/2018	SPS	Final Issue	RM	BS

**SUBMISSION FOR REFERENCE**



Westbrook Mills, Borough Road, Godalming, GU7 2AZ, UK  
 T +44 (0) 1463 520 400, F +44 (0) 1463 520 889  
 wsp.com



The Drax Power (Generating Stations) Order

Application Document Reference 2.5B  
 Single Unit Option  
 Indicative Plant Layout  
 - Gas Pipeline Route - Sheet 8 of 9

SCALE	1:750	CHECKED	R.MANN	APPROVED	B.SIBTHORP
PROJECT NO.	70037047	DESIGNED	B.SIBTHORP	DATE	27/04/2018

70037047-2.5B-IPL - SHEET 8 01

© WSP UK Ltd



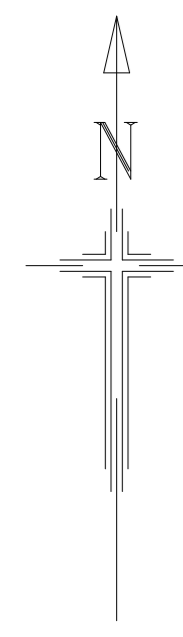

DO NOT SCALE

LEGEND  
— PROPOSED DCO ORDER LIMITS

TRAFFIC MANAGEMENT

ITEM	DESCRIPTION
19	TEMPORARY PASSING PLACE FOR GAS AGI CONSTRUCTION TRAFFIC

Drain

1.22m RL

4.0m

19

Def

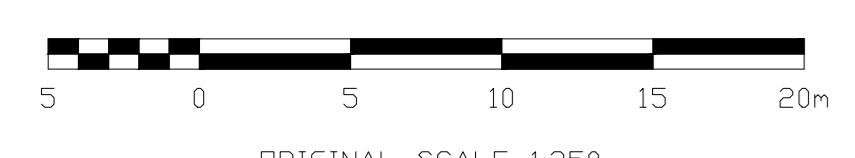

ORIGINAL SCALE 1:250

Infrastructure Planning (Applications: Prescribed Forms and Procedure) Regulations 2009 - Regulation 5(2) (a)

REV	DATE	BY	DESCRIPTION	CHK	APP
01	27/04/2018	SPS	Final Issue	RM	BS

DRAWING STATUS: S2 - FOR INFORMATION



Westbrook Mills, Borough Road, Godalming, GU7 2AZ, UK  
T: +44 (0) 1463 520 400, F: +44 (0) 1463 520 889  
wsp.com



PROJECT: The Drax Power (Generating Stations) Order

TITLE: Application Document Reference 2.5B  
Single Unit Option  
Indicative Plant Layout  
- Passing Place - Sheet 9 of 9

SCALE @ A0: 1:250	CHECKED: R.MAKIN	APPROVED: B.SIBTHORP
PROJECT NO: 70037047	DESIGNED: B.SIBTHORP	DATE: 27/04/2018

DRAWING NO: 70037047-2.5B-IPL - SHEET 9 REV: 01

© WSP UK Ltd